

# Expression™ Mobile Multimedia Cabinet

## Specifications – Model 101

### Physical Specifications

<b>Size</b>	Cabinet	41" W x 35 1/2" H x 27 1/8" D (104.1 cm x 90.2 cm x 68.9 cm)
	First-Surface Projector Mirror	14" W x 7 1/4" H (35.6 cm x 18.4 cm)
	Adjustable Shelves	
	– Projector Shelf	22" W x 16" D (55.9 cm x 40.6 cm)
	– Peripheral Shelf	22" W x 16" D (55.9 cm x 40.6 cm)
	– Mouse/Keyboard Shelf	9 7/8" W x 16" D (25.1 cm x 40.6 cm)
<b>Weight</b>	Cabinet	148 lb. (67.1 kg)
<b>Shipping Weight</b>	Cabinet and Crate	238 lb. (108.0 kg)
<b>Shipping Size</b>	Crate	44" W x 45" H x 32" D (111.8 cm x 114.3 cm x 81.3 cm)

All dimensions +/- 1/8" (3.2 mm). All weights +/- 2 lb. (0.9 kg).

### Cabinet

<b>Shell</b>	Melamine-surfaced wood composite construction Locking doors and mirror flap
<b>Cabinet Finishes</b>	Standard finishes: light wood grain (American natural) or blue
<b>Portability</b>	Roll-about, self-contained unit on four 3" (7.6 cm) lockable casters. Tie-down straps secure the internal tower computer and projector. An accessory kit to replace the casters with a permanent base can be ordered separately.
<b>Projector Support</b>	The available space on the projector shelf is 14" W x 16" D (35.6 cm x 40.6 cm). To determine if the projector you supply fits into this space, check the location of its cable connections and its fan. You must allow for 3" (7.6 cm) between the projector's fan and the wall or door of the cabinet. Also, you must have 3" (7.6 cm) on the connection panel side of the projector so that you have enough room for the cable connectors. When selecting a projector, make sure it has a maximum power rating of 500 W, a vertical throw angle (image offset) range of 8° to 18°, and a weight of less than 50 lb. (22.7 kg).
<b>Rack Mount Storage</b>	Space for three RU 19" W (48.3 cm) rack mount units. Accessory rack mount kits can be ordered separately.
<b>Mirror</b>	First-surface mirror (94% reflectance)
<b>Peripheral Support</b>	Shelving is vertically adjustable. An additional 22" W (55.9 cm) media shelf can be ordered separately.
<b>Load Capacity</b>	150 lb. (68.0 kg)
<b>Audio</b>	The audio system provides a comfortable listening level for PC, guest laptop, DVD player and VCR use in a room that's a maximum of 1,000 square feet (93 square meters), with a 30-person capacity (subject to room acoustics)
<b>Flip-up Shelf</b>	Mounted to the side of the cabinet, this accessory provides additional work space. Must be ordered separately.
<b>Cable Cleats</b>	External cleats for cable management
<b>Warranty</b>	One-year limited equipment warranty

### Audio System

<b>Mixer</b>	Unified audio system with line-level mixing of the computer and other connected audio sources
<b>Amplifier</b>	Amplifies the mixed audio; optimum for a room that's a maximum of 1,000 square feet (93 square meters) with a 30-person capacity
<b>Speakers</b>	Quality 4" (10.2 cm) diameter speakers for maximum audio clarity and performance

### Control Panel

<b>Volume Control</b>	Single volume control on the control panel for all audio sources
-----------------------	--

### Cable Access

<b>AC Power Outlet</b>	Supplies power to a guest laptop or another device
------------------------	--

### Power Management System

<b>Internal Power Bar</b>	15A at 125V AC with seven available outlets
<b>Internal Distribution</b>	An internal 12V DC power supply provides power for the cabinet's audio system
<b>Power Consumption</b>	SMART-supplied equipment draws 3A at 120V AC 60 Hz. Customer-supplied equipment must not cause power consumption to exceed 15A at 120V AC 60 Hz.

### Storage and Operating Specifications

<b>Storage</b>	-40° F to 95° F (-40° C to 35° C) with up to 95% humidity non-condensing
<b>Operation</b>	41° F to 85° F (5° C to 29° C) with up to 90% humidity non-condensing

## Specifications – Model 101

### Internal Cables

<b>Projector</b>	RGB HD DB15 S-video RCA Composite Video	Connects the projector to the computer Connects the projector to the DVD player (if available) Connects the projector to the VCR (if available)
<b>DVD Player</b>	S-video Dual RCA	Connects the video signal of the DVD player (if available) to the projector Connects the audio signal of the DVD player (if available) to the amplifier
<b>VCR</b>	RCA Composite Video Dual RCA	Connects the video signal of the VCR (if available) to the projector Connects the audio signal of the VCR (if available) to the amplifier
<b>Mouse/Keyboard</b> <b>Mouse/Keyboard</b>	PS/2 (two) USB	Connects a mouse and a keyboard to the internal computer Connects a USB mouse or a USB keyboard to the internal computer
<b>Audio</b>	3.5 mm Stereo Mini-Plug	Connects the amplifier to the internal computer

### External Cables

<b>Network</b>	CAT5e with RJ45 Coupler (F)	Connects the internal computer to a LAN (if available)
<b>Audio OUT</b>	Left and Right RCA Plugs	Connects to an external audio amplifier (if available)
<b>Power</b>	120V	Connects the Expression cabinet to a power outlet

### SMART Order Number

<b>SE2-101</b>	Expression 101 mobile multimedia cabinet <b>NOTE:</b> Peripheral equipment, such as an internal tower computer, projector, VCR, DVD player or SMART Board™ interactive whiteboard, is not included.
----------------	--

### Accessories

<b>SEA-810</b>	Flip-up Shelf	Mounts to the side of the Expression cabinet, providing additional work space
<b>SEA-820</b>	Wireless Kit	Provides a wireless connection between a SMART Board interactive whiteboard and the computer
<b>SEA-830</b>	Base Kit	Replaces the casters with a permanent base
<b>SEA-840-AN</b> <b>SEA-840-BLUE</b>	Media Shelf	22" W (55.9 cm) extra media shelf. Choose between light wood grain (American natural) or blue finish.
<b>SEA-850</b>	Rack Mount Kit	Allows for rack mount installation of peripherals

**SMART Technologies Inc.**  
Suite 300, 1207 – 11th Avenue SW  
Calgary, AB CANADA T3C 0M5  
Main Switchboard: 1.888.42.SMART (Canada/U.S.) or +1.403.245.0333 (all other countries)  
Support Tel: 1.866.518.6791 (Canada/U.S.) or +1.403.228.5940 (all other countries)  
Support Fax: +1.403.806.1256  
support@smarttech.com www.smarttech.com



# Expression™ Mobile Multimedia Cabinet

## Specifications – Model 101

Top View  
(Optional Flip-up Shelf Raised)

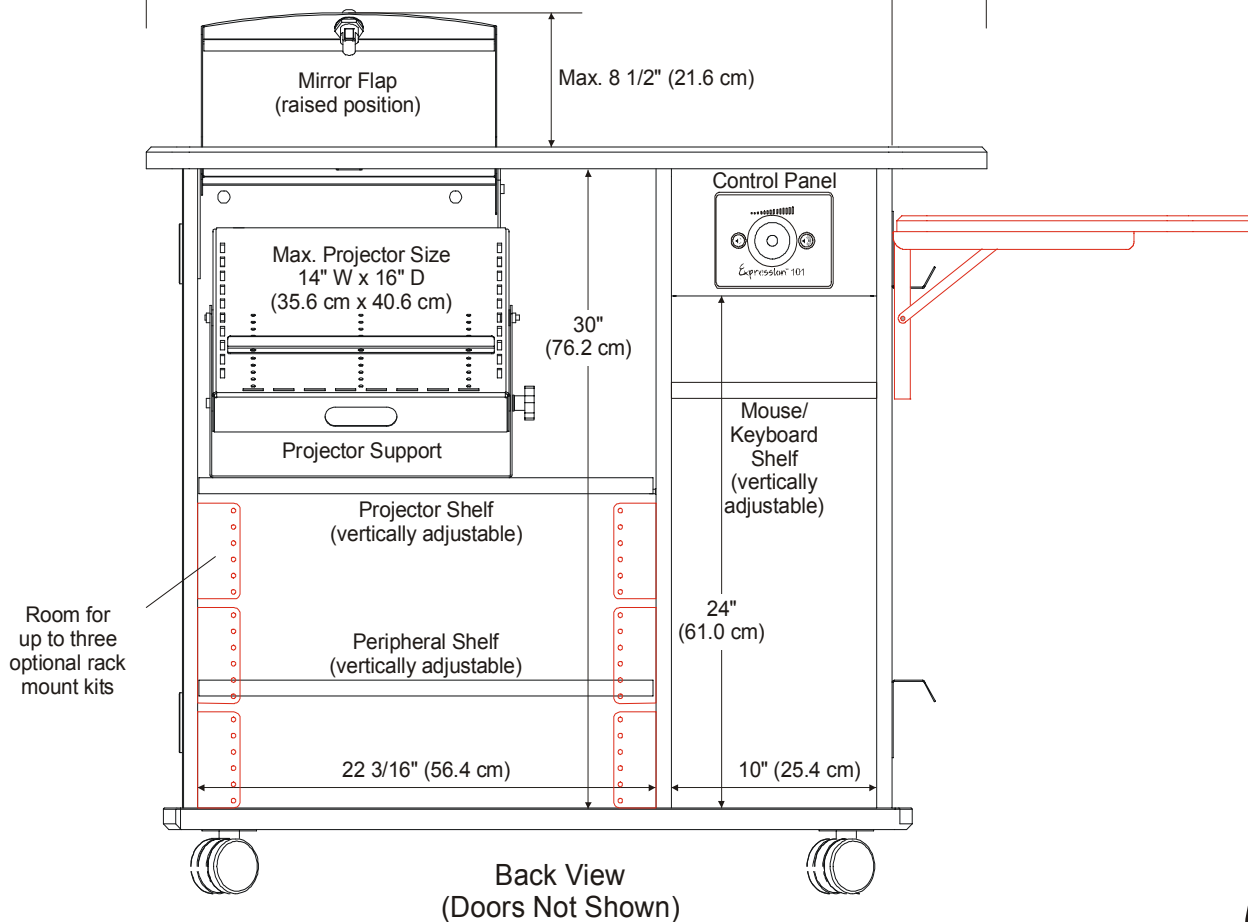
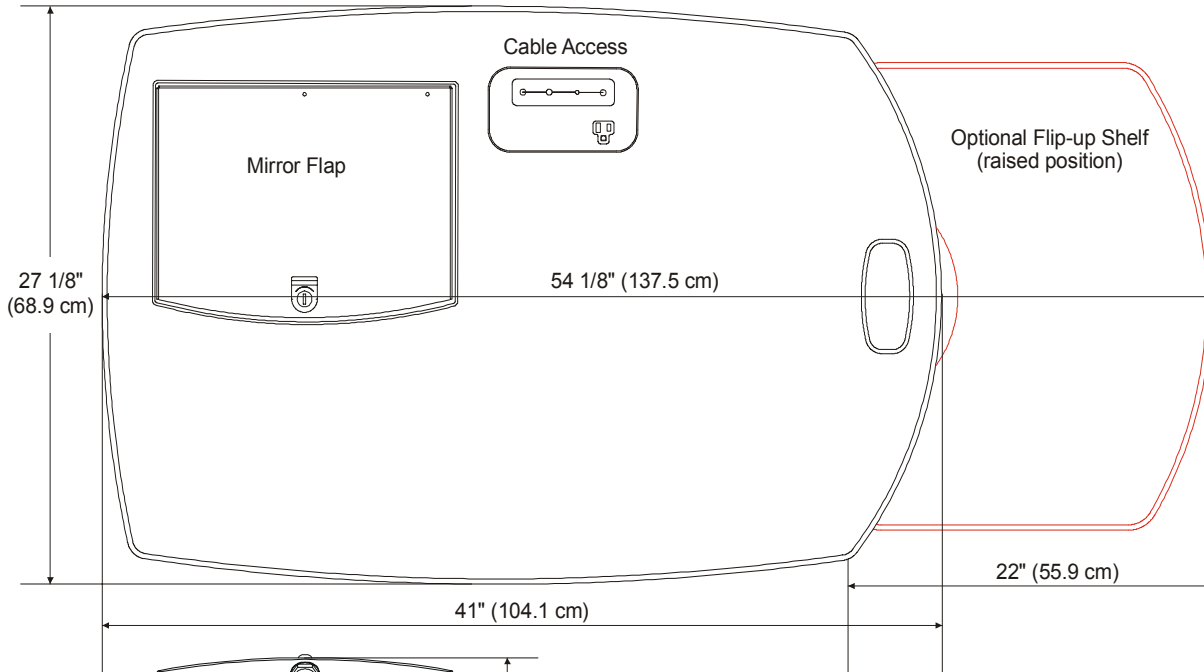

Back View  
(Doors Not Shown)

All dimensions are +/- 1/8" (0.3 cm)



# Expression™ Mobile Multimedia Cabinet

## Specifications – Model 101

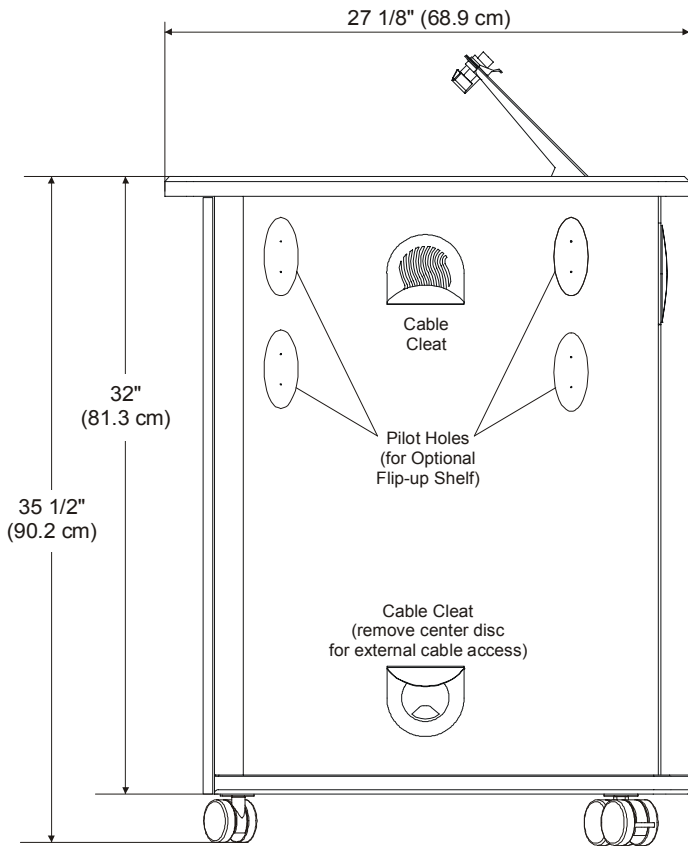

Side View  
(Mirror Flap Open)



Isometric View

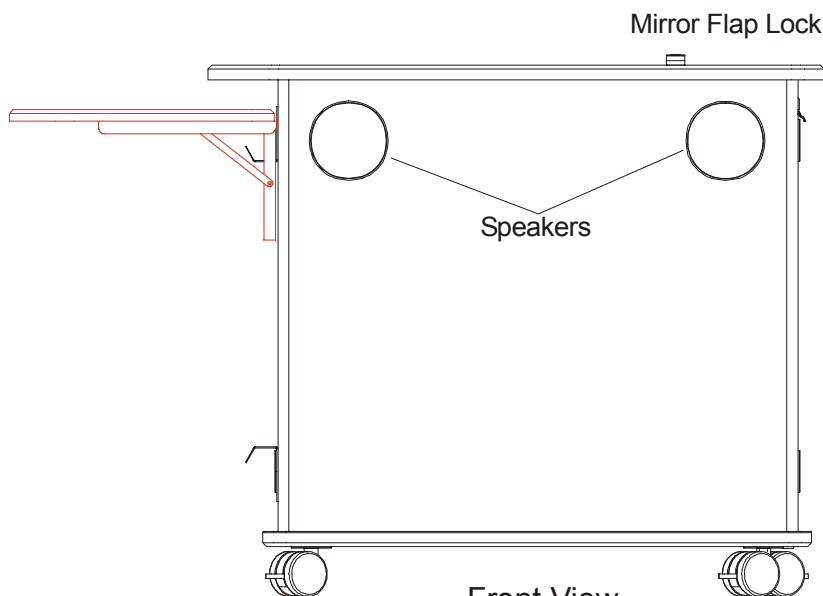

Front View  
(Optional Flip-up Shelf Raised)

All dimensions are +/- 1/8" (0.3 cm)

